



# What is wordee™

Wordee is a robot toy that you can draw with light. When wordee is moved like a mouse, its trajectory remains and glows. On the bottom of the wordee, there is an ultraviolet (UV) LED that blinks. A special sheet (phosphorescent sheet), in response to the light of ultraviolet rays, leaves a glowing trail. By linking wordee with a smartphone application (iOS, Android) you can display the words corresponding to the illustration displayed on the smartphone in Hiragana, Katakana, Kanji, English. Also, wordee can draw illustrations. You can draw immediately with wordee by creating a design with a smartphone application and sending the data to wordee. By using Wordee, you can enjoy this unique experience of drawing glowing trails of light.



## Product Specifications

Size	Width: 79 mm Length: 105 mm Height: 59 mm
Weight	Approximately 110g (including batteries)
Power supply	2 AAA batteries
OS	Android terminal equipped with Android OS 5.0 or later / iPhone 4S or later iPhone, 3rd generation or later iPad and iPad mini, iPad Air 5th generation or later iPod touch
Signal	Bluetooth Low Energy X.X
Detection sensor	acceleration sensor, infrared light sensor
Accessory	phosphorescent sheet, instruction manual
Main material	ABS resin

## Information of online manual



"There are manuals online for detailed usage of wordee and its applications. Please open the following link or access from QR code. You can also download smartphone applications from the online manual.

<http://jellyware.jp/gadget/wordee/manual/>

\*In order to improve performance and quality, product specifications and design may be changed without prior notice.

## Name of each part

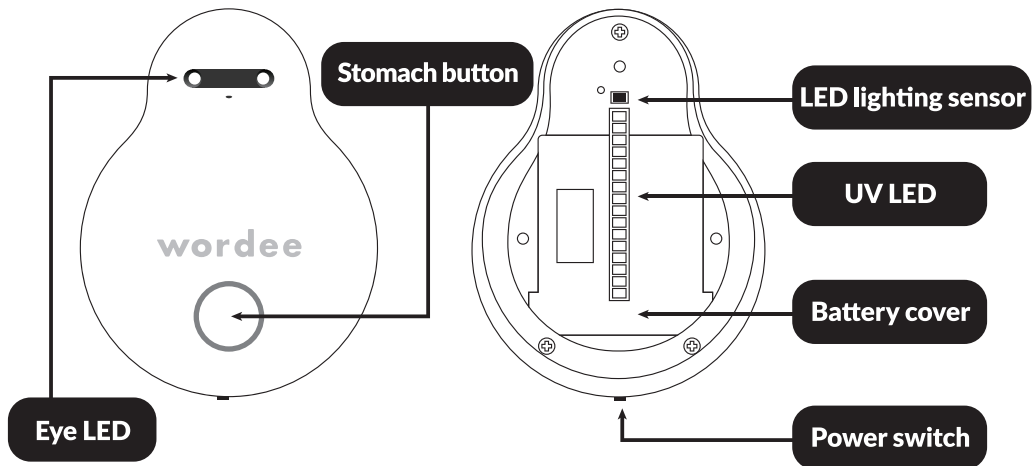

## About the condition of LED's eyes

Complete turn off	Power off state. Or battery exhaustion
Intermittent lighting	Stopped state
Always on	Moving state or not landing state
Flashing	Pairing ready state
One-side Flash	Data is being received from the device



## Other accessories to be used

- Two AAA batteries x 2 (indispensable)
- Phosphorescent sheet  
(standard accessory or optional)
- IOS device or Android device  
(recommended)

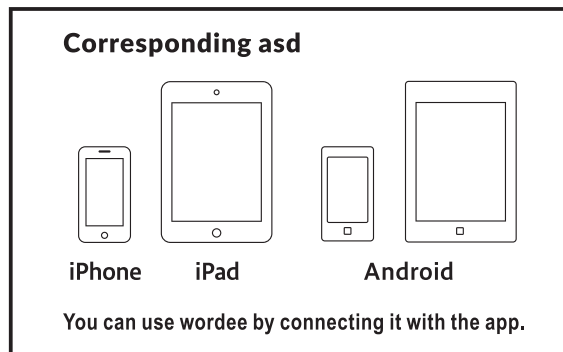

## Battery replacement method

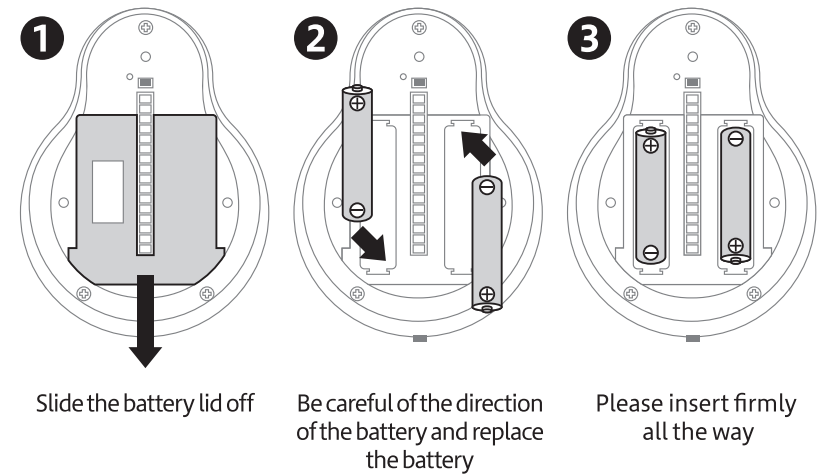

## Power (ON/OFF)

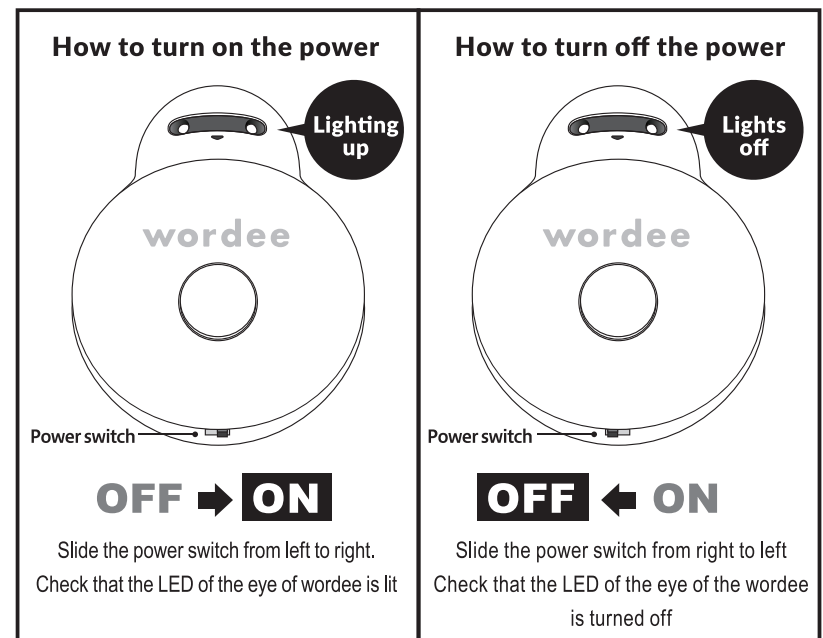

## Basic usage

- 1 When wordee is placed on the phosphorescent sheet and moved from "right to left" or "left to right", it can be drawn with light trails.

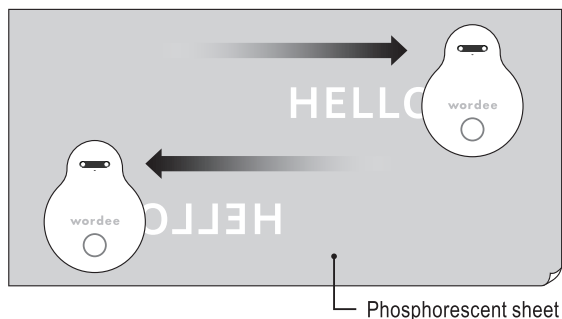

If you move it in the opposite direction without stopping it, the character is projected in a mirrored version.

- 2 When the moving speed is slow, the trail display expands, and if it is fast, the display shrinks. Keep constant speed and you can draw a beautiful trail of light display.

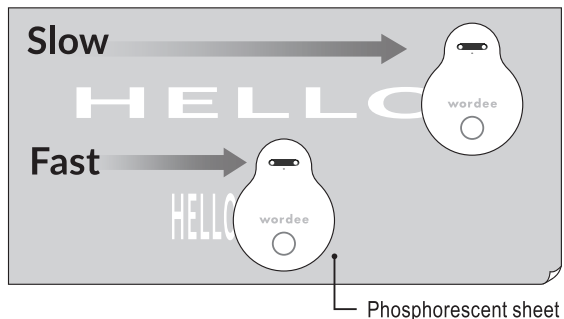

- 3 The content to draw depends on when you move from left to right and when you move from right to left. Please stop swiping when it does not switch well.

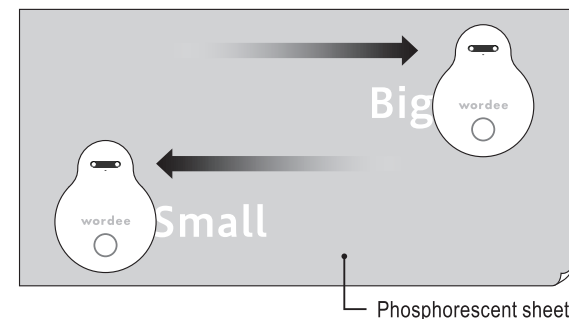

In the case of "Hanko" content it will be different letters.

※ If it turns into a mirror character, stop it once and check whether the LED on the eyes is turned off before you move wordee again.

- 4 When wordee leaves the surface of the phosphorescent sheet, the UV LED automatically turns off.

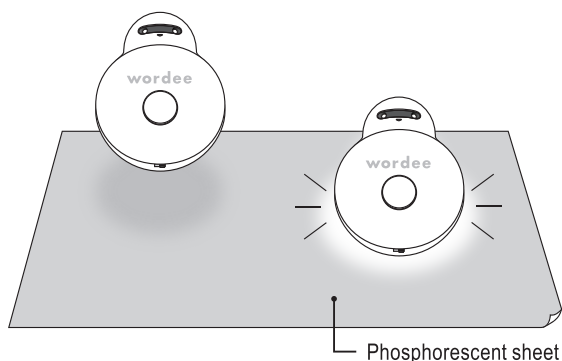

- 5 Pressing the stomach button briefly changes the display content. It holds 50 display contents in total, and when it is pressed 50th times, it returns to the 1st display. Pressing the stomach button for a long time will return display to the previous contents.

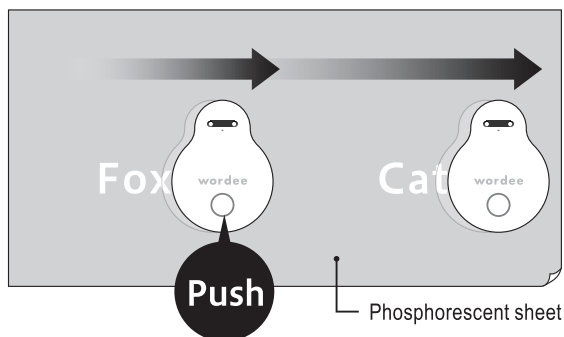

- 6 When stopping the movement of the wordee, the ultraviolet LED also turns off automatically.

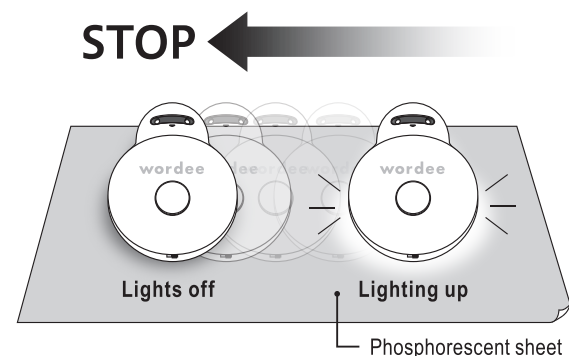

## Type of application

Wordee application consists of three types of play modes: "Drawing Book", "Drawing" and "Word" and the information page named "Help". In "Drawing Book" we are also preparing content such as "Quiz", "Illustration", and "Hobby". We plan to increase modes, contents, data etc. by upgrading from now on.

### Drawing Book

When you tap or swipe and select a picture, word data and illustration data are transferred to wordee.

Select "ひ" "力" "漢" "E", and you can change the language of word data and speech reading.

Tap the speaker icon to change the mode to either on/off.

In addition to operations on the screen, you can also move to the next data by pressing the button on wordee.

In case of using "Antonym" contents, word data changes depending on whether the "wordee" is moving right or left.



### Painting

When painting on a 16 x 16 size canvas and tapping the send button, the data will be transferred as an illustration to wordee.

Mainly drawn, you can modify by selecting white dots to erase the black parts.

When you tap the trash can icon, you can clear the whole content.

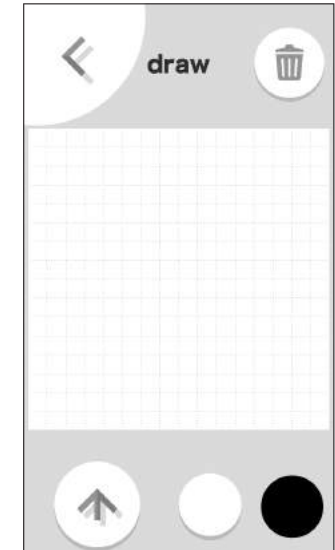

### Word

Enter a word in the text box and tap the send button to transfer the data to wordee. Tap the trash can icon to clear the content.



### Help

It leads to a link to the latest wordee "how to use" information.

Since it is a link to the website, please use when connected to the Internet.

You can check the detailed usage of the application from "How to use".



## Play with iOS / Android device

### Download of application

You can download it for free on the App Store for iOS devices and Google Play for Android devices. Search for "Wordee" and select the application with an icon that looks like the following image and which the vendor is "JellyWare Inc."



### Initial pairing

When connecting with wordee for the first time, or when connecting wordee apart from the wordee you connected last time, please do initial pairing.

**STEP1** Turn ON the power of the wordee, pressing the stomach button. Wordee's eye LEDs will start to blink.

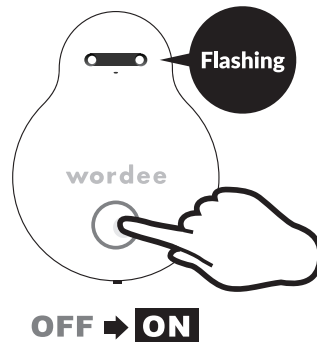

**STEP2** Launch the wordee application and select one of the "Drawing Book", "Drawing" and "Word" screens. (Please select contents such as "Land Animal" etc.)

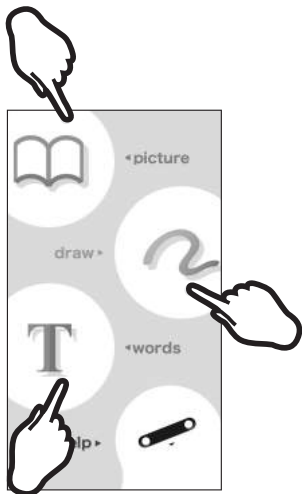

### Simple pairing

If you connect to the same wordee you connected previously, you can easily connect with simple pairing.

**STEP1** Turn on the power of wordee.

**STEP2** Launch the wordee application and select one of the "Drawing Book", "Drawing" and "Word" screens. (Please select contents such as "Land Animal" etc.)

**STEP3** Tap the button labeled "Pairing" and you're done.

**STEP3** Tap the button labeled "Pairing"

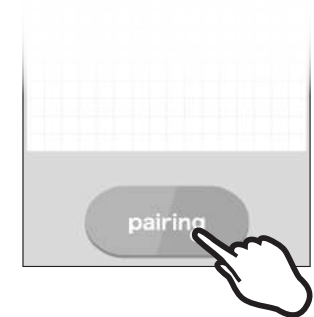

**STEP4** A pop-up message saying "Wordee \*\*\*\*" appears on the application screen, so tap it to finish. Wordee' eye LED returns to the normal lighting state.

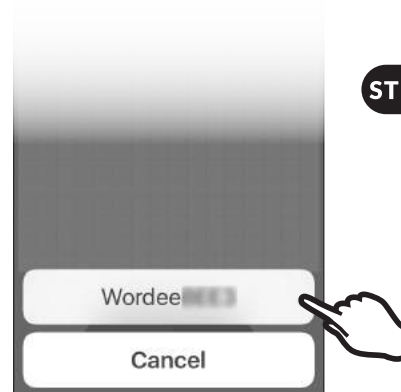

## Things to be careful when using wordee

- If you look directly at the UV LED there is an adverse effect on the eyes.
- If you exert too much force when moving wordee, there is a possibility that the sheet below will be scratched. Please do not use too much force. Also, the word's body cover may become loose.
- The batteries immediately after use may be hot. Please be careful when exchanging. Wipe gently with a soft cloth for care when the outer cover of wordee becomes dirty. Avoid using hot water, or paint thinner etc.
- When wordee is lifted from the sheet, there is a function that turns off the UV LED with the LED lighting sensor.

## Signs of Malfunction

### Cannot see the light trail

- ▶ You are not using a proper phosphorescent sheet
- ▶ The surroundings may be too bright

### The printed characters are inverted in display

- ▶ Stop movement and move wordee again

### Even if the power switch is turned on, the LED on the back side does not light up

- ▶ The distance between the phosphorescent sheet and the wordee is too far.
- ▶ Battery is not inserted.
- ▶ Battery is inserted in reverse order.
- ▶ Battery is low on energy.

### The Light trail is not being emitted

- ▶ Moving speed is too slow
- ▶ The surface on which the phosphorescent sheet is placed is not flat

### Even when you press the switch that is on wordee's stomach, and the pattern does not change

- ▶ Batteries are low on energy.

### I can not pair with my smartphone

- ▶ It is not in pairing mode
- ▶ You did not download application
- ▶ The distance between wordee and smartphone is too far away

### The LED on the back shines a bit

- ▶ Batteries are low

- But please be careful, because there is a possibility of false detection under incandescent light bulb or sunlight.
- In bright places such as outdoors, since the light drawn on the phosphorescent sheet is difficult to see, it is best to use wordee in a dark place.
- If the speed of moving wordee is very slow, it may be erroneously detected as a stopped state, and the drawing or illustrations may be cut off or become mirrored characters.
- Do not touch the ultraviolet LED or the LED lighting sensor directly with hands or apply shock. It may cause a malfunction.

## Rules for Warranty Repair

- If this product fails despite used in normal condition according to the instruction manual, we will repair it for you within 1 year from the date of purchase, free of charge.
- When you request free repair, please send the product and your warranty card.
- Even within the warranty period, repair fees will not be charged for the following cases.

- 1. When this warranty is not presented.**
- 2. When this warranty card is rewritten.**
- 3. When there is no presentation of material or data that clarifies the date of purchase, or if there is too much damage in the presentation materials.**
- 4. Errors in use, improper remodeling, or damage due to repair.**
- 5. Damage due to a drop in water or on the ground, etc. after purchase.**
- 6. Damage due to fire, earthquake, typhoon, flood damage, lightning strike or other natural disaster.**

- Because we will not reissue this warranty card, please keep it in a safe place.
- This product will be repaired by send-back method. In addition, it may be necessary to pay the return shipping fee.
- Please understand that we may exchange the product instead of repairing depending of the situation.
- When repairing, you may use recycled parts / alternative parts. In addition, we will arbitrarily recover and properly dispose parts replaced by repair.
- For products after free repair (including product replacement) based on this document, the warranty period at the time of initial purchase will be applied.
- We will not provide extra benefits caused by damage of the purchased product.
- Free repair is available only in Japan.
- In case of request for repair from overseas, shipping fee will be charged by the customer.

## Things to be careful when using wordee

### This about "death or serious injury is assumed" content.

- Do not disassemble or modify.
- Do not store, or use in high-humidity areas or areas where heat is likely to affect wordee (near the fire, near a heating appliance, in a kotatsu or a blanket, in a place exposed to direct sunlight, inside a car in a hot sun, etc.)
- Do not soak wordee with liquid such as water.
- Do not give strong force, shock, vibration such as dropping, stepping, or throwing.
- Do not look directly at the back of the UV LED light.
- Avoid contacting electrically conductive matters (metal pieces such as clips, pencil leads, etc.) from the opening of the battery box part, and also, prevent dust from entering inside. And finally, please do not insert foreign objects such as metal fragments and fragile objects.
- Turn off the wireless connection with the smartphone in the vicinity of electronic equipment that handles highly accurate control and weak signals. It may cause adverse effects such as malfunction of electronic devices.

※ Examples of electronic devices you want to note: Hearing aid, Implantable cardiac pacemakers and implantable defibrillators, other medical electrical equipment, and other automatic control equipment.

- If you are using implantable cardiac pacemakers, implantable cardioverter defibrillators, or other medical electrical equipment, please confirm the influence of radio waves to each medical electrical equipment manufacturer or distributor.
- Because there are restrictions on use within an aircraft, please follow the instructions of each airline.
- If you are experiencing abnormalities such as unusual odor, abnormal noise, smoke emission, heat, discoloration, deformation, etc. during use, please do the following.

- ▶ Turn off the power.
- ▶ Remove the battery.

## Caution

This content is about "Matters that might cause minor injury or physical damage" .

- Do not use it while it is broken.
- When used by an infant, please use it with adults.
- When removing the battery cover, please do not put more force than necessary. Also, do not pinch your fingers when installing.
- Be sure to insert the batteries in the right order.
- If you are not using this toy for a long time, please remove the battery.

## Warranty card

Item name	wordee		
Product No	JW-01A		
Customer	Name		
	Street address		
	Phone number		
Date of purchase	2017.02	Warranty period	1year
Sales outlet	JellyWare Inc. 160-0022 Vixel Shinjuku 1F 7-26-7 Shinjuku, Shinjuku-ku, Tokyo TEL : 03-6869-8917		

## Inquiries about how to use the product and repair

company name **JellyWare Inc.**  
Street address **160-0022 Vixel Shinjuku 1F 7-26-7 Shinjuku, Shinjuku-ku, Tokyo**

### Contact for product, repair, after-sales service

E-mail **wordee@jellyware.jp**  
TEL **03-6869-8917 (Phone bill will be on the customer)**  
Reception hours **9:00 ~ 17:00 (except Saturdays, Sundays and public holidays)**

Manual version number **JW01A-M-R00**

# JELLYWARE